

ArcoSport Spigarelli
Via Prenestina 252/e 00177 Rome Italy
www.spigasport.com
info@arcosportspigarelli.com



Hand Crafted Passion

INDEX

Welcome to the family	2
The parts of your bow	3
Limbs installation	4
String installation	5
Limbs adjustment	6
Draw weight adjustment.....	7
Suggested brace height.....	8
Brace adjustment	9
Tiller adjustment	10
Center shot adjustment.....	11
Warranty.....	12



Welcome to the family

Thank you for choosing us for your new riser. My name is Sante Spigarelli. As an athlete i took part to three olympic games, fourteen world cups, fourteen european championships and holded five world records. At a certain point of my career I understood that the time had come to give more to this sport and I decided to share my knowledge. Back in the 1976 I created this company with my wife and today I keep this passion alive with the rest of my family and most important with the help of my son Massimo. There are two key words that you have to remember while shooting your new Spigarelli: Passion and Family.

First of all passion. The passion for what you do is the engine that makes you go through even the darkest day. Passion animates every moment of our lives and makes us better than what we are. So while you hold your new riser think about it. Just look at it, feel it under your fingertips and think about all the passion that led us to the creation of this product. Remember, behind every bow there is a story and we hope that you will enrich it with your own passion for this sport.

Then we have our second, but not less important, key word: Family. For us, in Italy, the family it's one of the most important things in life. That's why you are so important. Now that you are the proud owner of a brand new Spigarelli riser you are not a simple customer but part of the Spigarelli family. Your trust feeds our will, our creativity, and our constant research for improvements. For us, all of you have the same importance, like in a family, we take care of the pro shooter and the absolute beginner in the same way. Last but not least remember that when we sell a riser it's not a simple piece of cold metal but a part of us, as you are.

Enjoy

Sante Spigarelli and Massimo Spigarelli | Experience and Energy at your disposal



2

The parts of your bow

1. Upper tip
2. Upper limb string groove
3. Upper limb
4. Bow string
5. Top tiller measure point
6. Upper weight/tiller bolt
7. Clicker
8. Plunger button holes
9. Brace height measure point
10. Grip
11. Stabilizer mounting hole
12. Lower weight/tiller bolt
13. Bottom tiller measure point
14. Bottom limb
15. Lower limb string groove
16. Lower tip

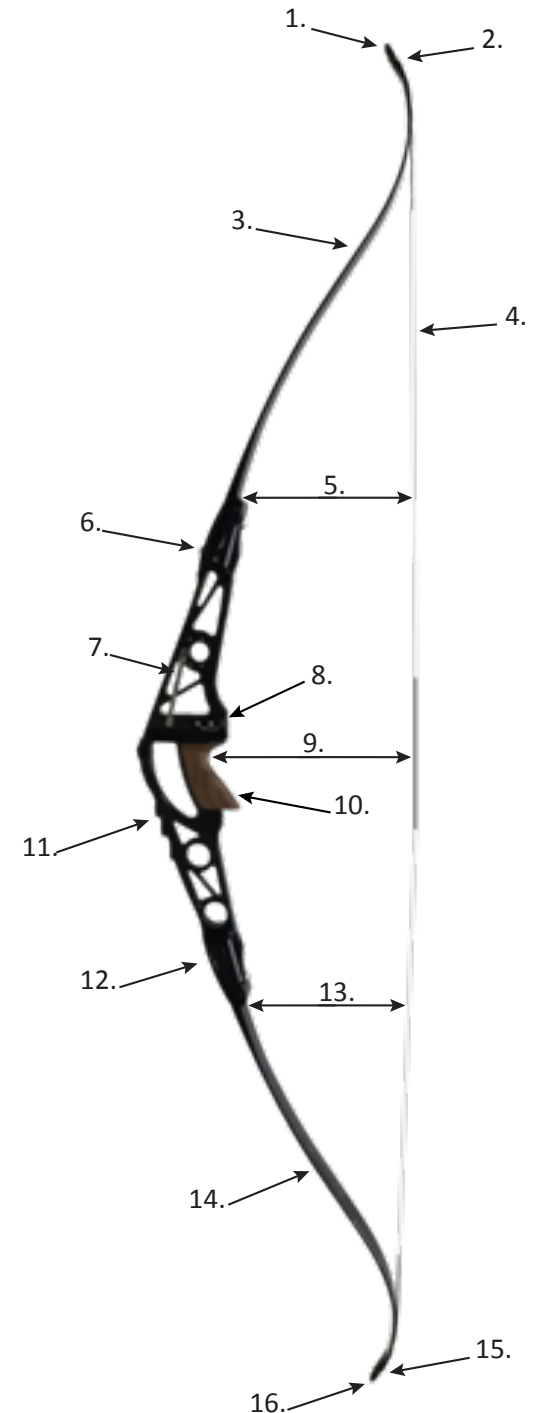
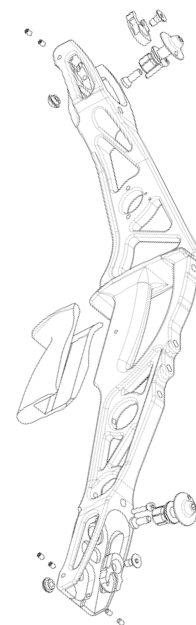

3

Limbs installation

Now that you know how your bow is composed we are ready to begin. First of all we are going to install the limbs.

IMPORTANT:

Before you proceed check that you own a pair of compatible limbs. Remember that your new Spigarelli is designed to fit ILF limbs. If your limbs are not ILF don't try to install them to avoid the risk of causing damage to the riser or the limbs and void the warranty. If you are not sure contact your reseller or feel free to contact us.

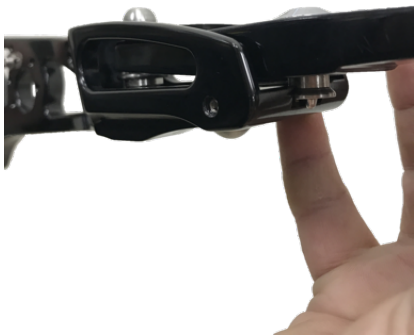

Place the bottom part of the limb in the riser pocket being sure that the dovetail bolt is aligned to his slot.

Push the limb inside the pocket until you feel a click coming from the dovetail detention ball and with the bottom part you reached the tiller bolt.



Job done!

4

String installation

Well, the limbs are on, now we have to install the string.

IMPORTANT:

Before you proceed check that you own a string of the correct length. The installation of an incorrect bowstring could cause damage to the riser or the limbs and void the warranty. If you are not sure contact your reseller or feel free to contact us.

IMPORTANT:

For your safety and to avoid risk of causing damage to the riser or the limbs always use a bowstringer to string and unstring your bow.

Usually bow strings have a larger and a smaller loop

Place the larger loop over the tip of the upper limb and slide it down.

Now place the smaller loop on the bottom limb string groove.

Place the stringer cup on the tip of the lower limb and slide the limb gripper over the upper tip and below the string loop.

Hold the bow horizontal by the riser grip with your non dominant hand and step on the bowstringer.

Now draw the bow up and with your free dominant hand slide the larger loop into the upper limb string groove.

Remove the bowstringer and check the string.



5

Limbs adjustment

The limbs are on and the string is installed let's have a look at the alignment. In order to proceed we will need a couple of limb line gauges or something similar to check the alignment of the limbs.

Install the limb line gauges on the lower part of the upper limb and on the upper part of the lower limb.

By aligning the string to the center of the riser and the limb line gauges we can have three situations.

The best one, everything is aligned and the check ends here ready for the next step.

The bow string sits on the left of the limb line gauges center.

The bow string sits on the right of the limb line gauges center.



If the bow string sits on the left of the limb gauges center we are going to remove the side locking screws of the pocket and watching the riser from the back we are going to unscrew the right adjustment screw and screw the left one. Then check again the alignment and repeat if necessary.



6

If the bow string sits on the right of the limb gauges center we are going to remove the side locking screws of the pocket and watching the riser from the back we are going to unscrew the left adjustment screw and screw the right one. Then check again the alignment and repeat if necessary.



Once everything is finally aligned don't forget to put back in place the side locking screws.

Draw weight adjustment

Keep on discovering all the features of your new Spigarelli, now we are going to see how to adjust the draw weight of your bow.

IMPORTANT:

Always unstringing your bow before you proceed. Adjusting the draw weight of your bow without unstringing could cause damage to the riser or the limbs and void the warranty.

First of all we need to unscrew the tiller bolt locking screw While holding the tiller bolt. For Revolution holders you will have to loose the locking nut that you will find at the same place of the locking screw.



7

Now turn the riser and looking at the tiller bolt simply turn it clockwise while holding the locking screw to increase the draw weight.



Or anticlockwise while holding the locking screw if you want to decrease the draw weight.

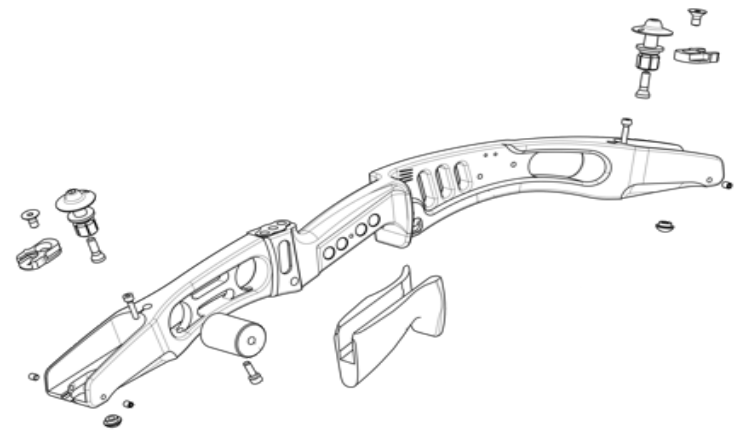

Once you have repeated the same procedure on both upper and bottom tiller bolts remember to screw back the tiller bolt locking screws or tight the locking nuts if you use a Revolution.

Suggested brace height

In the following chart you will find the brace heights that we suggest you to use with your new Spigarelli. At the same time we recommend you to have a look at the brace suggested by the producer of your limbs.

IMPORTANT:

Never use a strongly different brace than the one suggested in this chart to avoid the risk of causing damage to your riser or your limbs and void the warranty.

64"	From	7	To	8
66"	From	7.1/2	To	8.1/2
68"	From	8	To	9
70"	From	9	To	9.3/4

8

Brace adjustment

Now that you know which brace you should use let's see how to adjust it. In order to proceed we are going to need a bow square.

IMPORTANT:

Once again remember never use a strongly different brace than the one suggested in this chart to avoid the risk of causing damage to your riser or your limbs and void the warranty.

Measure the brace height with your bow square from the groove of the grip to the bow string



If the brace height is too high unstringing the bow and reduce the number of the bow string twists. String back the bow, check and repeat if necessary.

If the brace height is too low unstringing the bow and increase the number of the bow string twists. String back the bow, check and repeat if necessary.

9

Tiller adjustment

Don't give up we are almost ready to shoot!
Let's have a look at the tiller adjustment. The bow square is one of our best friends and we are going to use it again in order to proceed.

IMPORTANT:

Never use strongly different tiller setting than the common ones to avoid the risk of causing damage to your riser or your limbs and void the warranty.

First of all measure the tiller height.

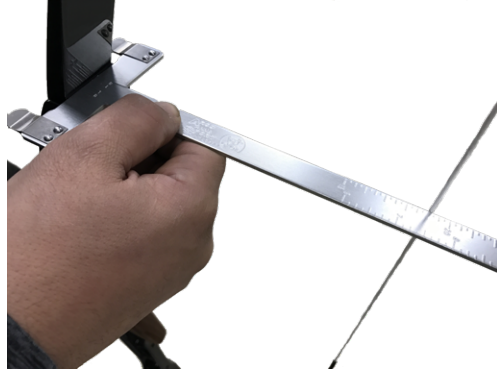

If you want to increase the tiller height the procedure is the same as if you want to increase the draw weight. Remember that if you want to keep the same draw weight you have to subtract the exact same number of turns from the other tiller bolt.

If you want to reduce the tiller height the procedure is the same as if you want to decrease the draw weight. Remember that if you want to keep the same draw weight you have to add the same exact number of turns to the other tiller bolt.

Now that you are satisfied with your tiller remember to double check both tiller and brace height and repeat the adjustment procedures if needed.

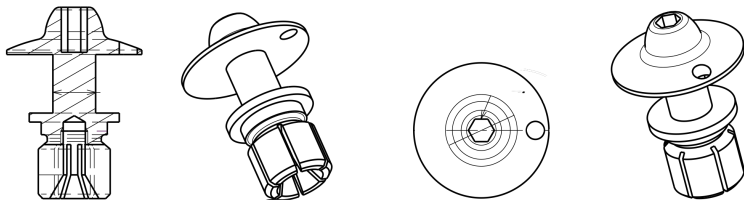

10

Center shot adjustment

One last thing and then you can proudly take your brand new Spigarelli to the practice field, the center shot.

Once again we are going to use the limb alignment gauges to help us completing the task.

Nock on an arrow and as we have done for the limbs align the string to the center of the riser and the limb line gauges.

Now we are going to look at where the point of the arrow sits if at the right, the center or, as it should be, slightly at the left of the string.

By adjusting your plunger settings here is the result you should achieve.



As you can see the point sits at the left of the string with the whole shaft almost tangent to the bowstring.

11

